

POP3 and IMAP Accounts on the iPod Touch

Those freebie, Web-based accounts are super-easy to set up. But they're not the whole ball of wax. Millions of people have a more generic email account, perhaps supplied by their employers or Internet providers. They're generally one of two types:

- **POP accounts** are the oldest, most compatible, and most common type on the Internet. (POP stands for Post Office Protocol, but this won't be on the test.) But a POP account can make life miserable if you check your mail on more than one machine (say, a PC and an iPod Touch), as you'll discover shortly.

A POP server transfers incoming mail to your computer (or iPod Touch) before you read it, which works fine as long as you're using only *that machine* to access your email.

- **IMAP accounts** (Internet Message Access Protocol) are newer and have more features than POP servers, and are quickly catching up in popularity. IMAP servers keep all of your mail online, rather than making you store it on your computer; as a result, you can access the same mail from any computer (or Touch). IMAP servers remember which messages you've read and sent, and even keep track of how you've filed messages into mail folders. (Those free Yahoo email accounts are IMAP accounts, and so are Apple's MobileMe accounts and corporate Exchange accounts. Gmail accounts *can* be IMAP, too, which is awesome.)

There's really only one downside to this approach: If you don't conscientiously delete mail after you've read it, your online mailbox eventually overflows. On IMAP accounts that don't come with a lot of storage, the system sooner or later starts bouncing new messages, annoying your friends.

The iPod Touch can communicate with both kinds of accounts, with varying degrees of completeness.

Tip The Touch generally copies your IMAP messages onto the iPod itself, so you can work on your email even when you're not online. You can, in fact, control where these messages are stored (in which mail folder). To see this, open [Settings](#)→[Mail, Contacts, Calendars](#)→your IMAP account name→[Account Info](#)→[Advanced](#). See? You can specify where your Drafts, Sent messages, and Deleted messages wind up on the iPod.

If you haven't opted to have your account-setup information transferred automatically to the Touch from your Mac or PC through the Info tab in iTunes, you can set it up manually right on the iPod.

From the Home screen, tap **Settings**→**Mail, Contacts, Calendars**→**Add Account**. Tap **Other**, and then enter your name, email address, password, and an optional description. Tap **Save**.

Apple's software attempts to figure out which kind of account you have (POP or IMAP) by the email address. If it can't make that determination, you arrive at a second screen now, where you're asked for such juicy details as the Host Name for Incoming and Outgoing Mail servers. (This is also where you tap either **IMAP** or **POP**, to tell the iPod what sort of account it's dealing with.)

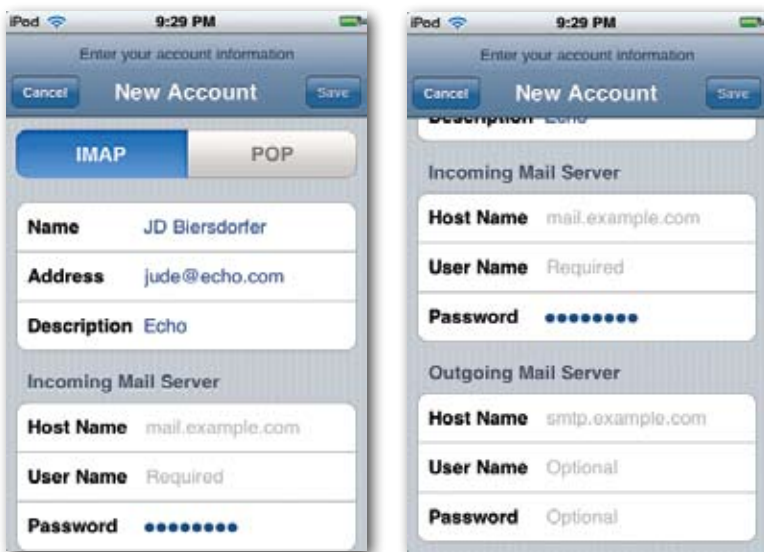

If you don't know this stuff offhand, you'll have to ask your Internet provider, corporate tech-support person, or next-door teenager to help you.

When you're finished, tap **Save**.

Tip To *delete* an account, open **Settings**→**Mail, Contacts, Calendars**→account name. At the bottom of the screen, you'll find the **Delete Account** button.